

DIY PROJECT

Proudly supplied by

Resene

the paint the professionals use

MATERIALS

You need: • 2 x 1800mm x 900mm trellis panels with 50mm square mesh • 13m x 45mm x 35mm H3.2 fence capping • 4 x 1800mm x 100mm x 75mm fence posts • 1 x 1200mm x 150mm x 25mm fence paling • 2 litres Resene Waterborne Woodsman stain in 'Bushtrack' • 2 galvanised handles • 2 hook and eye latches • 6g x 38mm countersunk screws • 8g x 50mm countersunk screws • power saw • power drill • clamps

Cutting measurements

From the trellis panels cut: • 2 x 780mm x 685mm pieces • 2 x 780mm x 780mm pieces.

From the fence capping cut: • 4 x 720mm lengths • 12 x 820mm lengths • Cut the ends of each fence capping length at a 45° angle.

From the fence paling cut: • 4 x 900mm x 28mm lengths.

Cost \$236.52 (plus paint)

DIY COMPOST BIN

Speed up the composting process with this easy-to-build, well-aerated compost bin that has a simple sliding front panel, says Jane Wrigglesworth

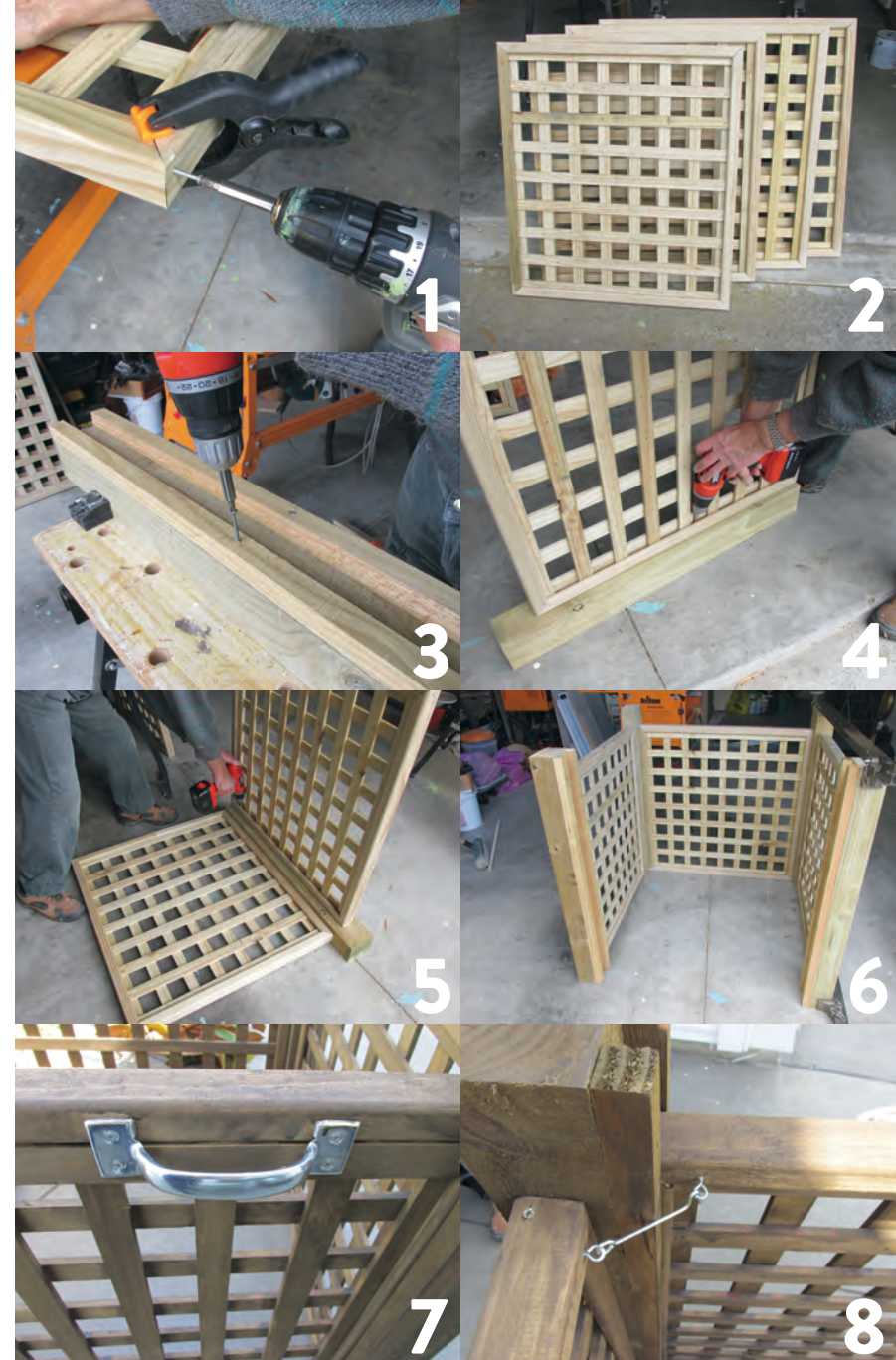

1 Fit 4 x 720mm and 4 x 820mm capping lengths to the two smaller panels. Cut capping further, if necessary, to fit snug. Screw together, using 38mm screws.

2 Make up the larger panels, using the remaining fence capping lengths. Cut capping, if necessary, then screw in place.

3 To make the guides, position 2 x 900mm x 28mm fence paling lengths on the edges of one fence post (on 100mm side) and, using 50mm screws, screw in place. Repeat on the second fence post.

4 Attach the two smaller panels to posts without the guides (on 75mm side). Screw in between slats with 50mm screws.

5 Attach one of the large panels to the two posts that have the two smaller panels attached, to form a U-shape. Use 3 x 50mm screws per side.

6 Attach the two posts with the guides at the front of the compost box. Another set of hands or a large clamp is helpful here.

7 Cut the remaining piece of fence paling to fit across the length of the front panel beneath the capping. Screw. Stain bin. Attach handles when dry.

8 Slide front panel in place. Attach the hook and eye latches at the top of the front panel on the inside, at the corners, to keep the sides from pushing out.

PHOTOS: JASON CREAGHAN; JANE WRIGGLESWORTH;